

MiniONE[®] Button

Low Profile Balloon Gastrostomy Tube



Reduce Leaks

Improve Comfort

Soft + Flexible

Glow Green[™] Technology



Innovating. Educating. Changing Lives.[™]

AMT MiniONE® Balloon Button



Exclusive AMT Balloon
Superior Gastric Seal



Soft + Flexible
Optimized for Comfort

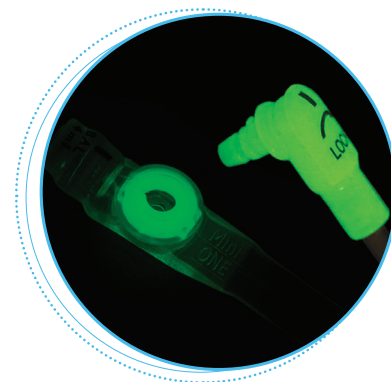

Glow Green™
Easier Nighttime Feeds

An Advantage in Enteral Nutrition

Reduce Leaks

The MiniONE® Balloon Button was designed to reduce gastric leakage that can cause nutrient loss, skin damage and granulation tissue

- **Exclusive AMT Balloon**
apple-shaped, expands horizontally
>50% more internal stoma coverage¹
- **Tapered Transition**
from bolster to tube, for a more secure fit
- **Anti-Reflux Valve**
prevents backflow
- **Adjustable Balloon Volume**
ensures proper fit

Soft + Flexible

- **Flexible External Bolster**
easy to clean around the stoma site
- **Balloon Fill Port**
angled away from the body to reduce skin irritation at the stoma site
- **Gentle to the Skin**
designed to reduce granulation tissue

Improve Comfort

AMT understands that comfort is key when it comes to patient, caregiver and clinician satisfaction

- **37% Lower External Profile¹**
MiniONE® lays discreetly below clothing
- **30% Lower Balloon Profile¹**
occupies less space within the stomach



Brody

Amery

Your **ONE** Source for Enteral Nutrition Devices. Accessories. Resources. Support.

MiniONE[®] Balloon Button

37% Lower Profile¹
External Bolster

Glow Green[™] Feed Port
Feed The Green

Balloon Fill Valve
Angled to Reduce Irritation

Anti-Reflux Valve
Tapered Transition

Soft + Flexible

Competitor Device

Rigid

Superior Gastric Seal
>50% More Coverage¹

Adjustable Balloon Volume
Ensures Proper Fit

30% Lower Profile¹
Within The Stomach

Safe + Secure Feed Set Attachment

To attach a feed set to a MiniONE[®] Balloon Button, follow these easy steps:

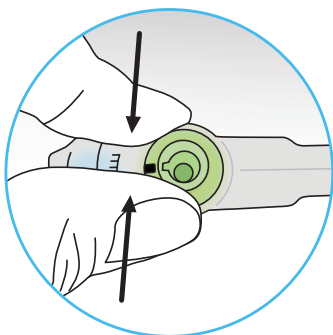

STABILIZE

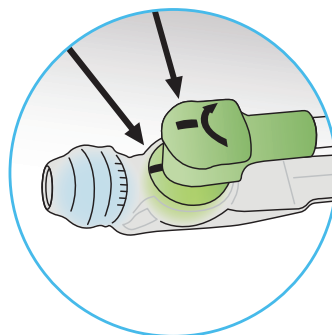

ALIGN & INSERT

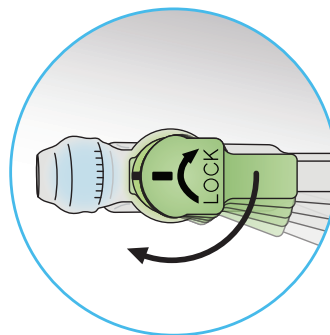

ROTATE

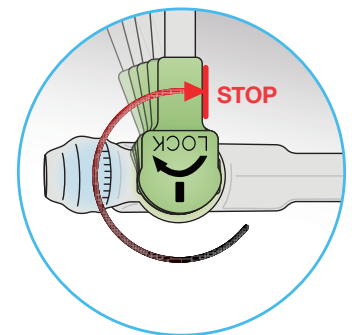

LOCK

Proper Fit Every Time

To ensure a proper fit, it is crucial to measure the stoma length using the AMT Balloon Stoma Measuring Device

BALLOON STOMA MEASURING DEVICE	ORDER #	PACKAGED
GUIDEWIRE COMPATIBLE	1804	10/BOX
NON-GUIDEWIRE COMPATIBLE	1704	10/BOX

MiniONE® Balloon Button

LENGTH cm	12 F		14 F		16 F		18 F		20 F		24 F	
	LEGACY	ENFit®	LEGACY	ENFit®	LEGACY	ENFit®	LEGACY	ENFit®	LEGACY	ENFit®	LEGACY	ENFit®
0.8	M1-5-1208	M1-5-1208-I	M1-5-1408	M1-5-1408-I	M1-5-1610	M1-5-1610-I	M1-5-1810	M1-5-1810-I	M1-5-2010	M1-5-2010-I		
1.0	M1-5-1210	M1-5-1210-I	M1-5-1410	M1-5-1410-I	M1-5-1612	M1-5-1612-I	M1-5-1812	M1-5-1812-I	M1-5-2012	M1-5-2012-I		
1.2	M1-5-1212	M1-5-1212-I	M1-5-1412	M1-5-1412-I	M1-5-1612	M1-5-1612-I	M1-5-1812	M1-5-1812-I	M1-5-2012	M1-5-2012-I		
1.5	M1-5-1215	M1-5-1215-I	M1-5-1415	M1-5-1415-I	M1-5-1615	M1-5-1615-I	M1-5-1815	M1-5-1815-I	M1-5-2015	M1-5-2015-I	M1-5-2415	M1-5-2415-I
1.7	M1-5-1217	M1-5-1217-I	M1-5-1417	M1-5-1417-I	M1-5-1617	M1-5-1617-I	M1-5-1817	M1-5-1817-I	M1-5-2017	M1-5-2017-I	M1-5-2417	M1-5-2417-I
2.0	M1-5-1220	M1-5-1220-I	M1-5-1420	M1-5-1420-I	M1-5-1620	M1-5-1620-I	M1-5-1820	M1-5-1820-I	M1-5-2020	M1-5-2020-I	M1-5-2420	M1-5-2420-I
2.3	M1-5-1223	M1-5-1223-I	M1-5-1423	M1-5-1423-I	M1-5-1623	M1-5-1623-I	M1-5-1823	M1-5-1823-I	M1-5-2023	M1-5-2023-I	M1-5-2423	M1-5-2423-I
2.5	M1-5-1225	M1-5-1225-I	M1-5-1425	M1-5-1425-I	M1-5-1625	M1-5-1625-I	M1-5-1825	M1-5-1825-I	M1-5-2025	M1-5-2025-I	M1-5-2425	M1-5-2425-I
2.7	M1-5-1227	M1-5-1227-I	M1-5-1427	M1-5-1427-I	M1-5-1627	M1-5-1627-I	M1-5-1827	M1-5-1827-I	M1-5-2027	M1-5-2027-I	M1-5-2427	M1-5-2427-I
3.0	M1-5-1230	M1-5-1230-I	M1-5-1430	M1-5-1430-I	M1-5-1630	M1-5-1630-I	M1-5-1830	M1-5-1830-I	M1-5-2030	M1-5-2030-I	M1-5-2430	M1-5-2430-I
3.5	M1-5-1235	M1-5-1235-I	M1-5-1435	M1-5-1435-I	M1-5-1635	M1-5-1635-I	M1-5-1835	M1-5-1835-I	M1-5-2035	M1-5-2035-I	M1-5-2435	M1-5-2435-I
4.0	M1-5-1240	M1-5-1240-I	M1-5-1440	M1-5-1440-I	M1-5-1640	M1-5-1640-I	M1-5-1840	M1-5-1840-I	M1-5-2040	M1-5-2040-I	M1-5-2440	M1-5-2440-I
4.4			M1-5-1444	M1-5-1444-I	M1-5-1644	M1-5-1644-I	M1-5-1844	M1-5-1844-I	M1-5-2044	M1-5-2044-I	M1-5-2444	M1-5-2444-I
5.0			M1-5-1450	M1-5-1450-I	M1-5-1650	M1-5-1650-I	M1-5-1850	M1-5-1850-I	M1-5-2050	M1-5-2050-I	M1-5-2450	M1-5-2450-I
5.5			M1-5-1455	M1-5-1455-I	M1-5-1655	M1-5-1655-I	M1-5-1855	M1-5-1855-I	M1-5-2055	M1-5-2055-I	M1-5-2455	M1-5-2455-I
6.0			M1-5-1460	M1-5-1460-I	M1-5-1660	M1-5-1660-I	M1-5-1860	M1-5-1860-I	M1-5-2060	M1-5-2060-I	M1-5-2460	M1-5-2460-I
6.5			M1-5-1465	M1-5-1465-I								
7.0			M1-5-1470	M1-5-1470-I								
8.0			M1-5-1480	M1-5-1480-I								
9.0			M1-5-1490	M1-5-1490-I								
10.0			M1-5-14100	M1-5-14100-I								

*The MiniONE® Balloon Button comes packaged as 1/box.

Feed Sets Included in Kit

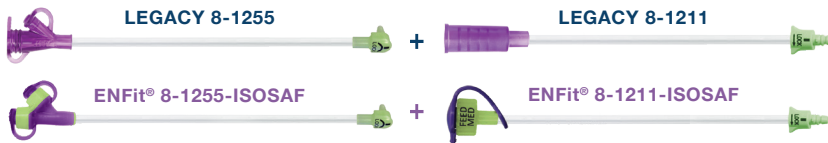

Balloon Fill Volumes

FRENCH SIZE	MIN	REC.	MAX
12F	2 ml	2.5 ml	3 ml
14F	3 ml	4 ml	5 ml
16F	4 ml	6 ml	8 ml
18F	6 ml	8 ml	10 ml
20F	7 ml	10 ml	15 ml
24F	7 ml	10 ml	15 ml

Recommended water fill volume is clearly printed on each MiniONE® Balloon Button fill valve. Consult your healthcare provider before adjusting fill volumes.

Complete Portfolio – Feed Sets

ADAPTER OPTIONS	RIGHT ANGLE CONNECTOR OPTIONS			STRAIGHT CONNECTOR OPTIONS		
	2"	12"	24"	2"	12"	24"
Purple Bolus		8-1221	8-2421	8-0211	8-1211	8-2411
Clear Y-Port XL	8-0222	8-1222	8-2422	8-0212	8-1212	
Purple Y-Port		8-1257G ¹ 8-1255	8-2455			
Single ENFit®		8-1221-ISOSAF 8-1223-ISOSAF 8-1226-ISOSAF	8-2421-ISOSAF 8-2423-ISOSAF	8-0211-ISOSAF	8-1211-ISOSAF	8-2411-ISOSAF
Dual ENFit®	8-0222-ISOSAF	8-1222-ISOSAF 8-1255-ISOSAF	8-2422-ISOSAF 8-2455-ISOSAF	8-0212-ISOSAF	8-1212-ISOSAF	

Feed Sets Not Made with PVC: 8-1255-ISOSAF-NP, 8-2455-ISOSAF-NP and 8-1211-ISOSAF-NP. MiniONE® Balloon Button feed sets are compatible with Mic-Key® devices.

¹ Y-Port with enhanced med port plug. Feed sets come packaged as 10/box.

LEGACY ENFit®

For a complete list of products visit us at www.AppliedMedical.net
 800 869 7382 | CS@AppliedMedical.net | ICS@AppliedMedical.net



MiniONE® Button



Applied Medical Technology, Inc.
 8006 Katherine Boulevard
 Brecksville, OH 44141
www.AppliedMedical.net
 An ISO 13485 Registered Company
 Cleared For Initial Placement
 MFR Conditional
 Made In USA



© 2021 Applied Medical Technology, Inc. C-3922-L

Patents: <http://www.AppliedMedical.net/Patents/> | Trademarks: <http://www.AppliedMedical.net/Trademarks/>
 Mic-Key® is a registered trademark of Avent, Inc. | ENFit® is a registered trademark of GEDSA. | 1.Claims based on internal testing of 14F devices.