

ATLAS[®] U-Stitch

Suture Delivery System

NEW

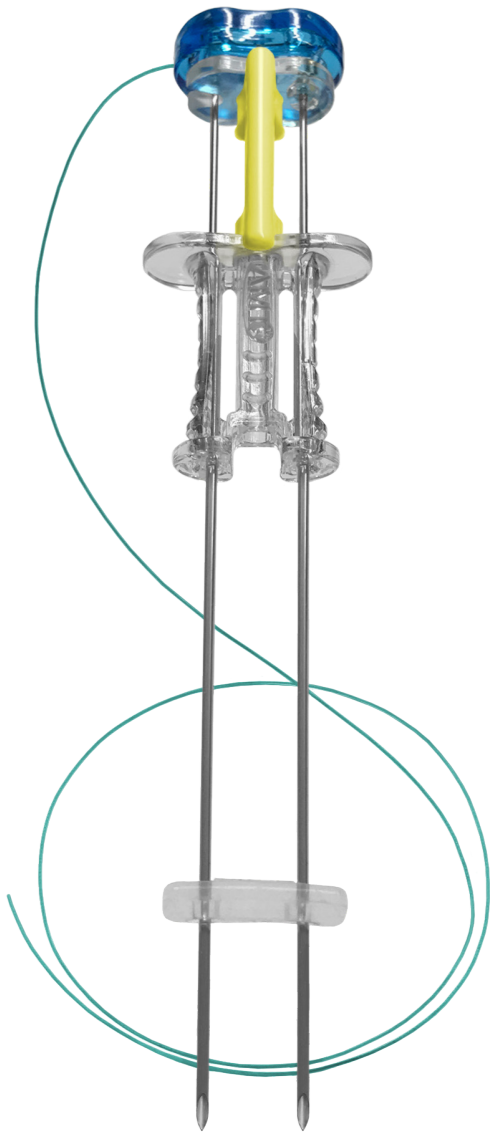

Automation + Ease

Magnetic Technology greatly increases the simplicity of placing a U-Stitch suture.

Uniform Suture Pattern

The suture placement is consistent and precise with fixed needle spacing.

Soft + Low Profile Bumper

36% smaller area, 20% lower profile, and greater than 77% softer bumper versus the leading competitor.¹

Metal Free Securement

Suture U-Stitch loop can reduce the pressure on tissue, thereby minimizing the risk of embedding.

The Benefits of a U-Stitch with the ease of a T-Fastener



Innovating. Educating. Changing Lives.™

800 869 7382 | CS@AppliedMedical.net | ICS@AppliedMedical.net

ATLAS[®] U-Stitch

Suture Delivery System with Magnetic Technology

Benefits for Providers + Patients

Developed for surgeon ease of use, the ATLAS[®] U-Stitch uses Magnetic Technology to quickly and safely form a U-Stitch within the hollow viscus. After proper placement, the organ is secured to the abdominal wall. Patients may benefit from the atraumatic design of the device. It is designed to decrease the possibility of adverse events during this process.

- Device can be placed within any hollow viscus of the abdomen including the stomach, bladder, small intestine, and large intestine.
- Reliable magnet connection only occurs within the hollow viscus, designed to minimize the chance of deployment within the surrounding tissue.
- The U-Stitch suture technique is an accepted standard of care for many patient populations, with proven results.²
- The optional Device Bumper optimizes securement by accommodating multiple standard tie-down configurations.

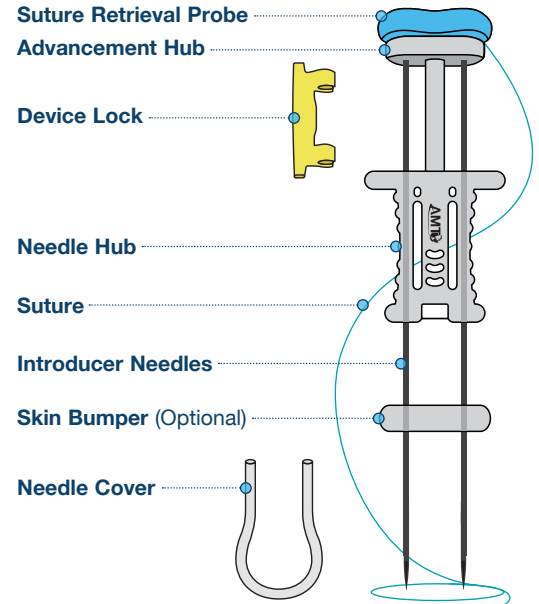

Prompt Placement*

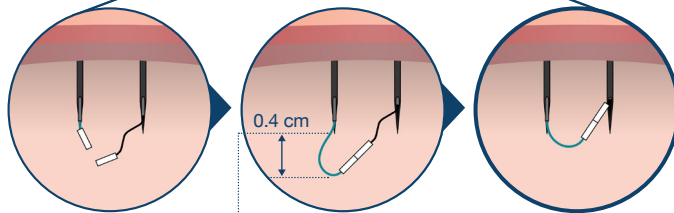
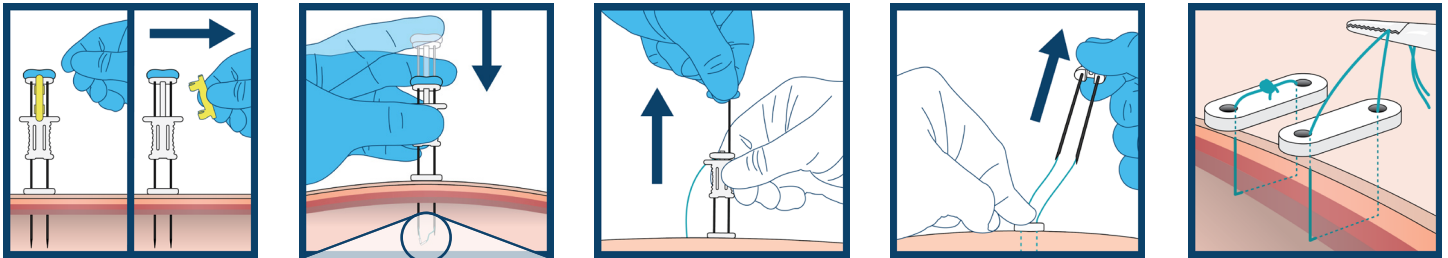

Magnetic Transfer Clearance

ATLAS[®] U-Stitch

ORDER NUMBER	TRAYS	QTY/BOX
1 DEVICE PER TRAY		
SD121-05-101	1	1
SD121-05-105	1	5
2 DEVICE PER TRAY		
SD121-05-201	2	2
SD121-05-205	2	10

For a complete list of products, visit us at www.AppliedMedical.net
800 869 7382 | CS@AppliedMedical.net | ICS@AppliedMedical.net



AppliedMedical.net



Applied Medical Technology, Inc.
 8006 Katherine Boulevard
 Brecksville, OH 44141
www.AppliedMedical.net
 An ISO 13485 Registered Company
 MR Safe once suture is properly placed + delivery device is removed
 Made In USA



© 2025 Applied Medical Technology, Inc. C-4767-B

Patents: <http://www.AppliedMedical.net/Patents/> | Trademarks: <http://www.AppliedMedical.net/Trademarks/>

*This document is not a substitute for the IFU/DFU (Instructions for Use/Directions for Use). Bumpers are optional and not required for proper placement technique. Must be placed under endoscopic visualization.

1. Based on internal testing. | 2. Seifarth, F.G. et al. JLSL. 2015(1).